

Portable mini disc player

instruction manual

Thank you for your purchase.

警告 Failure to follow safety precautions for electrical products can result in fire or personal injury. This instruction manual describes important precautions to prevent accidents and how to handle the product. Please read this instruction manual carefully before using the product safely. After reading it, be sure to keep it in a place where you can see it at any time. Please see the back side for the precautions for "for safety".

MZ-E620

© 2003 Sony Corporation Printed in Japan



"Walkman" and "WALKMAN" are registered trademarks of Sony Corporation, which represent headphone stereo products. WALKMAN is a registered trademark of Sony Corporation.

Check the accessories

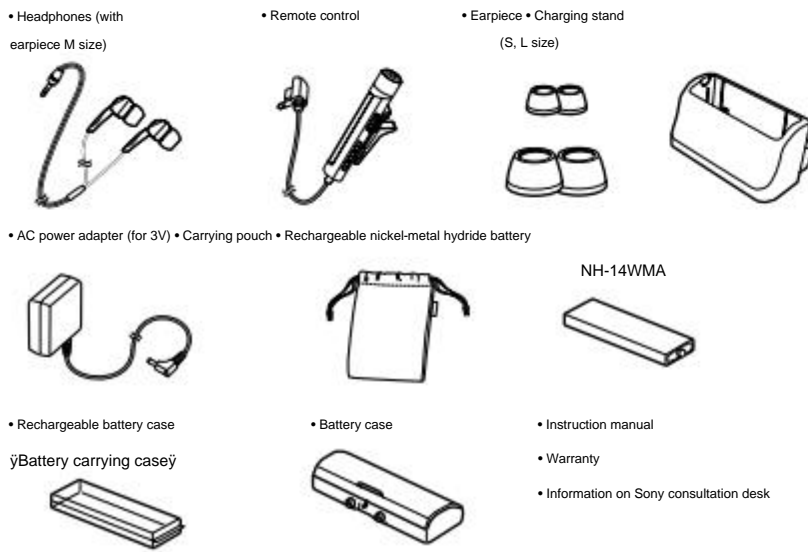

Name of each part

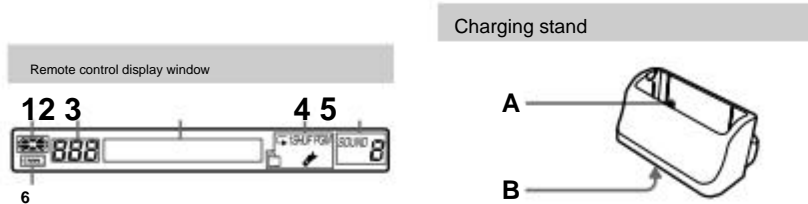
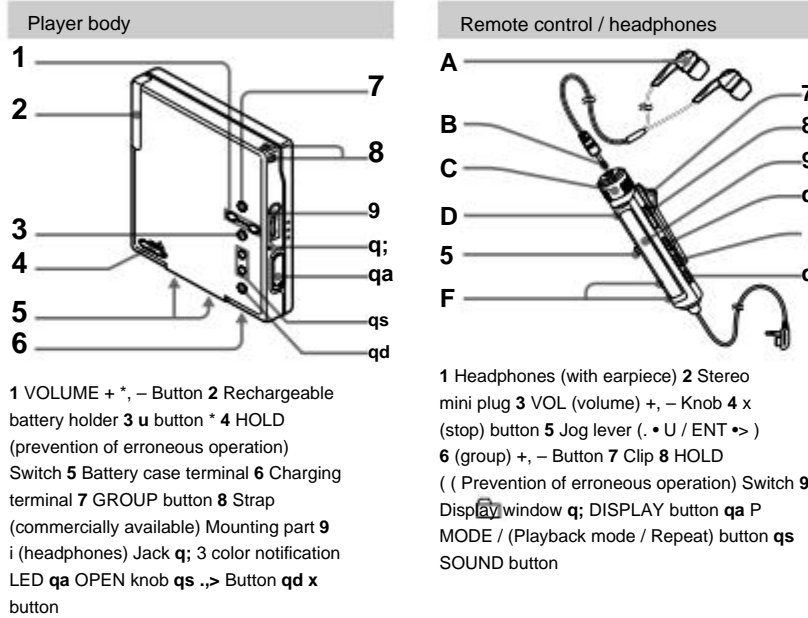

1 Disc display 2 Song number display 3 Character information display 4 Playback mode display 5 6 Band equalizer display 6 Battery level display

1 terminal for charging 2 DC IN 3V jack (bottom) The button has a convex point (protrusion). Eyes of operation Please use it as a mark.

prepare

Please charge the rechargeable battery first before using.

1 Insert the rechargeable battery

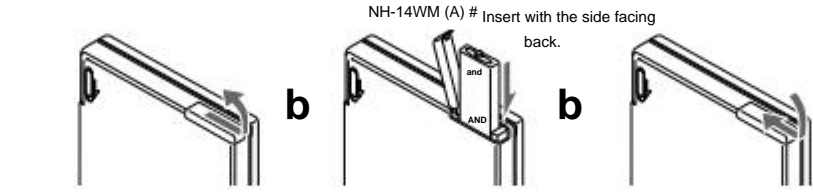

2 Charge

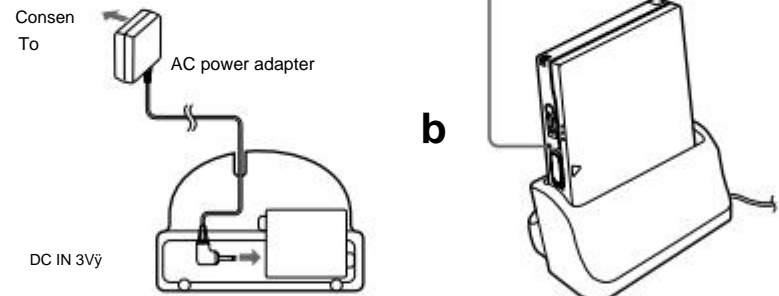

The charging status is notified by the "3-color notification LED". Red 1 Orange 1 Off (after about 3.5 hours) You can use it when the LED goes out. (When the remote control is connected, "CHARGING" is displayed on the display window while charging.)

please note Charging will stop if you perform operations such as playback while charging.

3 Connect the remote control and release the hold

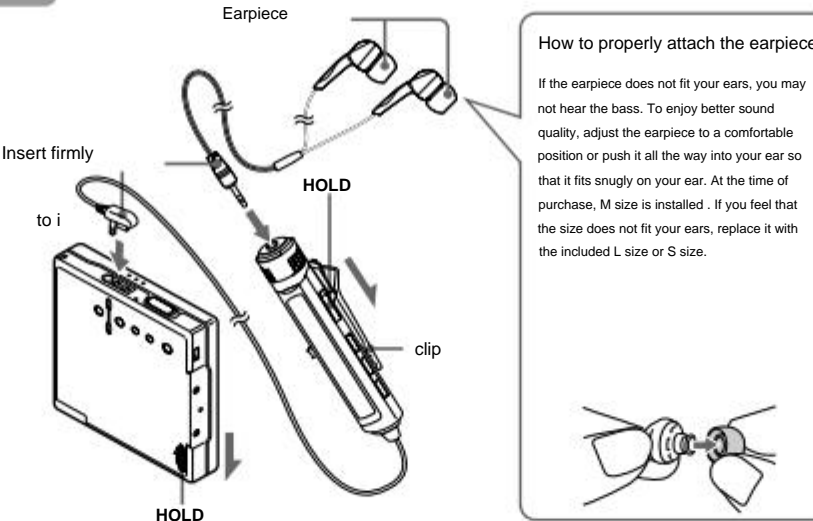

How to use the clip on the remote control Depending on the position where the remote control is installed, the direction of the characters appearing on the display window may be upside down, making it difficult to read. In that case, attach the remote control clip in the opposite direction as shown below.

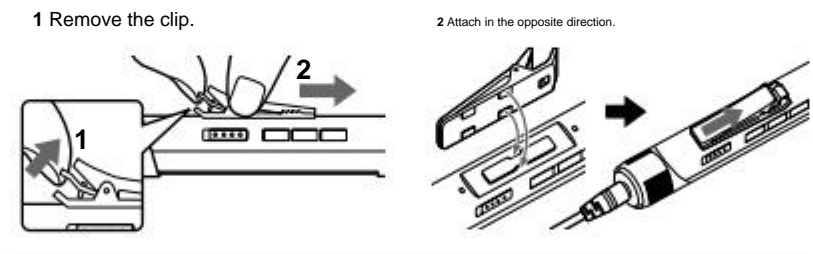

When using with alkaline batteries

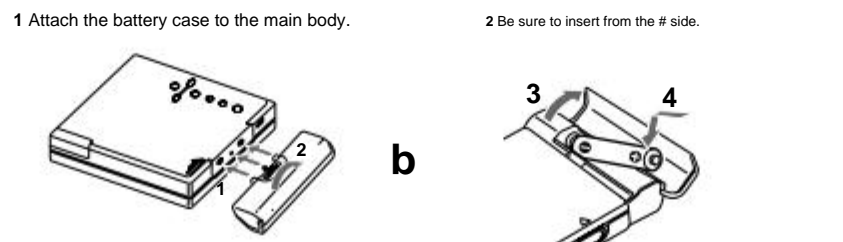

Insert one Sony alkaline battery (AA) sold separately. It can be played for a long time when used with a rechargeable battery.

Listen to the minidisc

1 Insert a mini disc

1 Move the OPEN knob in the direction of the arrow. 2 Insert a mini disc. 3 Close the lid.



With the label side of the disc facing up, push it all the way in the direction of the arrow.

2 play

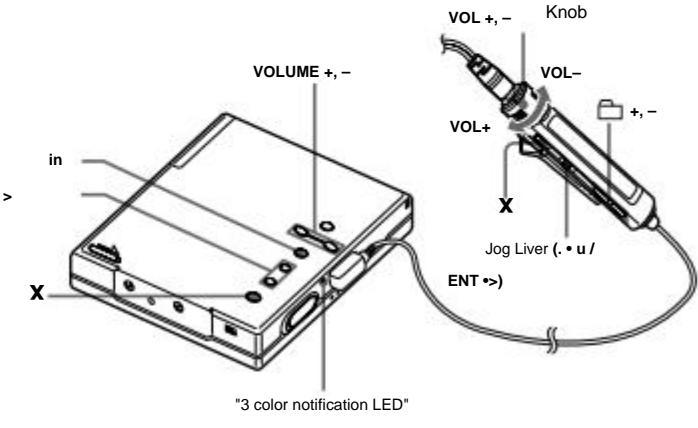

1 Press the jog lever (u) (press u on the main unit). You will hear a beeping sound. The "3-color notification LED" lights up in red (lights up in green when the disc is set as a group). 2 Turn the VOL knob to the + or - side to adjust the volume (press VOLUME + or - on the main unit). You can check the volume in the display window of the remote control.

Press the x button to stop playback. You will hear a beeping sound. The next time you play, it will start from the continuation where you stopped. If you want to start playing from the first song on the disc, hold down the jog lever (u) for at least 2 seconds (on the main unit, hold down u for at least 2 seconds) and start playing.

In such a case	Operation (continuation sound)
Pause	Press u. (Pi-Pi-Pi...) Press it again to cancel.
Cue to the song you are listening to or the song before	Move the jog lever to the side. (Press. On the main unit.) (PiP) (PiP)
Cue the next song	Move the jog lever to > side. (Press-> on the main unit.) (Pi)
Fast rewind or fast forward while playing	Keep the jog lever shifted to the Side or> side. (On the main unit, hold down Or>.)
Find the place you want to hear while looking at the elapsed time (time search)	While paused, keep the jog lever shifted to the Side or> side.
Search for the place you want to hear while looking at the song number (index search)	While stopped, keep the jog lever shifted to the Side or> side.
Cue every 10 songs (1)	Press the + and buttons.
Remove the disc (2)	After pressing x, move the OPEN knob on the main unit.

1) During group playback, the group will be cued (group skip). For details, "Play as a group" please look at. 2) When you open the lid, the next playback will start from the beginning of the disc.

B Various ways to listen

From here, the explanation mainly uses the buttons on the remote control.

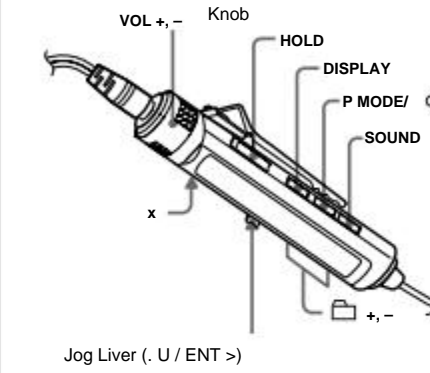

Jog Lever (. U / ENT =>)

See song titles and song times

You can check the song name, disc name, song number, elapsed time of the song, number of recorded songs, group name, and total number of songs in the group.



1 Press DISPLAY. Each time you press it, the display changes as follows.

A	B
Disc name	elapsed time
Disc name	Song title
Total number of songs in the group Group name	
Disc name	Disk name
Disc name	Sound mode
Disc name	SP / LP mode

please note • Group playback / normal playback status and operation status Depending on the status and setting status, the display may not be selectable or the display may differ.

• SP / LP mode is displayed only during playback, and after a while, it automatically returns to the elapsed time display.

Select a playback mode

1 Press P MODE / repeatedly. Each time you press it, the display changes as follows, and it plays back in the selected display state.



Playback mode display	Playback state
(no display)	Normal playback (play all songs on the disc once)
1	Play one song (play only the song that is currently playing)
2	Bookmark playback (play only songs with bookmarks in order)
SHUF	Shuffle playback (play all songs in random order)
PGM	Program playback (play the songs you want to listen to in the order you like)
3	Group normal playback (play once for each group in order from group 1)
4 SHUF	Ingroup shuffle playback (no)
5	Shuffle the songs in the live group
6	Replay, then the next glue in order
7	Shuffle the songs in the song)
8 PGM	Group program playback (glue)
9	Arrange in the order you like

* Displayed only when the disc is set as a group increase.

Select and listen to only your favorite songs (bookmark playback)

You can add bookmarks to your favorite songs and play only those songs. However, you cannot change the order of the songs.

To bookmark 1 Play the song you want to bookmark and press the jog lever for 2 seconds or longer.

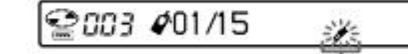

Bookmark flashes slowly

The bookmark is confirmed.

2 Repeat step 1 to bookmark To go. You can add up to 15 songs in total.

To play a bookmarked song

1 During playback, press P MODE / repeatedly to display "PLAY?". 2 Press the jog lever. Playback starts in order from the smallest song number with the bookmark.

To delete bookmarks

Play the song you want to unbookmark and press the jog lever for at least 2 seconds.

please note The setting is canceled when the lid is opened.

Arrange the songs in the order you like and listen (program playback)

1 During playback, "PGM" is displayed Then press P MODE / repeatedly. 2 Repeat the jog lever to select the song number and press to confirm.

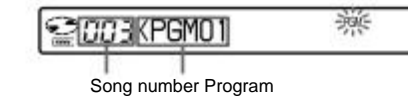

order 3 Repeat step 2 to select songs in the order you like. You can program up to 15 songs in total. 4 After selecting, press the jog lever for 2 seconds or longer. Playback starts in the programmed order.

To play a group program

Display "PGM" in step 2 above, and then perform steps 2-4. Plays in the order of the programmed groups.

The program settings remain even when playback ends or is stopped halfway.

please note The setting is canceled when the lid is opened.

Group play

What is a grouped disk?

A disc that is recorded and edited by dividing the songs on one disc into several groups using an MD recorder. This is convenient when you want to manage by grouping by CD album or artist. This unit can play discs that have been set as a group for each group.

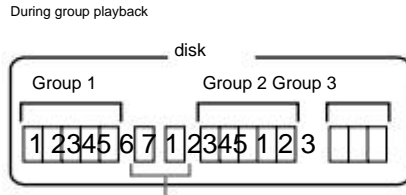
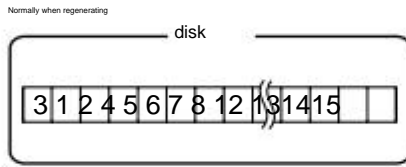

Songs that are not in the group are considered to belong to "Group --".

After playing each group in order from group 1, the songs that are not in the group ("Group --") are played and finished.

please note You cannot set groups on this unit. Set it with an MD recorder, etc.

1 During playback, press P MODE / repeatedly to display "GROUP".

To cue a group (skip a group) Remote control operation 1 Press + or - during playback. Press the - button to move to the first song in the group, and then press it again to move to the first song in the previous group.

Main unit operation 1 Press GROUP during playback.

2. Press or->

With the "3-color notification LED" lights green during group playback and flashes orange during group cueing.

Listen repeatedly (repeat playback)

You can listen to normal playback, single song playback, shuffle playback, program playback, etc. repeatedly. 1 Playing in your favorite playback mode, Press P MODE / for 2 seconds or longer. ** Lights up.

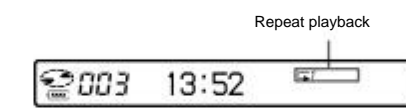

To cancel, press P MODE / for 2 seconds or longer.

z During repeat playback, press P MODE / to change the playback mode while keeping the repeat mode.

Make the sound you like (6 band equalizer)

You can select and set your favorite sound quality from 6 types with the remote control.

1 During playback, press SOUND repeatedly to press Select "SOUND". 2 Press SOUND for 2 seconds or longer. 3 Repeat the jog lever to select the sound type.

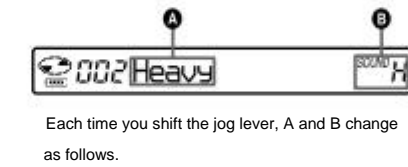

Each time you shift the jog lever, A and B change as follows.

A	B
Heavy	SOUND H
Peeps	SOUND P
Jazz	SOUND J
Unique	SOUND U
Custom1	SOUND 1
Custom2	SOUND 2

4 Press the jog lever to confirm.

To stop the setting on the way

Press the DISPLAY button or x button for at least 2 seconds.

To cancel the setting

Select the state where nothing is displayed in B in step 1 above.

Make the sound quality you like

You can store your favorite sound quality in "Custom 1" and "Custom 2".

1 Perform steps 1 to 3 above to display "Custom 1" or "Custom 2". 2 Press the jog lever to confirm. 3 Repeat the jog lever to select the frequency.

"Beep Off", and press to confirm. The confirmation sound of the remote control and the main unit disappears.

To stop the setting in the middle, press the DISPLAY button or x button for 2 seconds or longer.

To sound the confirmation sound Select "Beep On" in step 3 above.

Turn on / off the backlight of the remote control display window

1 Press DISPLAY for 2 seconds or longer. 2 Shift the jog lever Select "Backlight" and press to confirm To. 3 Shift the jog lever and select the setting.

status	setting
Auto	Lights during operation. Turns off after a while (setting at the time of purchase)
On	Always lit during operation
Off	Always off

4 Press the jog lever to confirm.

BVarious settings

Suppresses sound leakage and makes the sound easy on the ears (AVLS — Auto Volume Limiter System — Comfortable Volume)

You can listen at a more comfortable volume by reducing the risk of sound leakage due to excessive volume increase, pressure on your ears, and inability to hear surrounding sounds.

1 During playback, press DISPLAY for 2 seconds or longer.

2 Shift the jog lever, select "AVLS", and press to confirm. 3 Shift the jog lever, select "AVLS On", and press to confirm.

"AVLS On" is displayed.

To set on the main unit,

during playback, move the HOLD switch in the direction of ., and hold down the VOLUME - button. Move the HOLD switch in the opposite direction.

To cancel AVLS

On the remote control, select "AVLS Off" in step 3 above and press the jog lever. On the main unit, move the HOLD switch in the direction of during playback, and while pressing the VOLUME + button, move the HOLD switch in the opposite direction.

Turn off the confirmation sound

You can turn off the confirmation sound of the remote control and the main unit.

1 Press DISPLAY for 2 seconds or longer. 2 Shift the jog lever, select "Beep", and press to confirm. 3 Shift the jog lever, select "Beep Off", and press to confirm. The confirmation sound of the remote control and the main unit disappears.

1 Press DISPLAY for 2 seconds or longer. 2 Shift the jog lever Select "Power Mode" and press to confirm.

To stop the setting in the middle, press the DISPLAY button or x button for 2 seconds or longer.

To turn on the "3-color notification LED" Select "Normal" in step 3 above.

Listen to the sound quickly (Quick mode)

After pressing the play button or cueing a song, you can quickly hear the playback sound.

1 Press DISPLAY for 2 seconds or longer.

2 Shift the jog lever Select "Power Mode" and press to confirm.

3 Shift the jog lever, select "Quick", and press to confirm. "Quick" is displayed.

To stop the setting on the way

Press the DISPLAY button or the x button for at least 2 seconds.

To cancel the setting

Select "Normal" in step 3 above.

please note • When the setting is set to "Quick", the power is always on inside the main unit even when nothing is displayed on the screen. Therefore, it is recommended to charge the battery every day as the battery life will be shortened. • No operation (including opening and closing of the lid)

Then, after 17 hours, the power inside the main unit will be turned off automatically. The next operation will be slower, but after that it will be in quick mode again.

Reduce battery consumption (Power save function)

It is a function to maximize the battery life. You can reduce battery consumption by constantly turning off the "3-color notification LED" on the main unit or turning off the remote control display shortly after operation.

1 Press DISPLAY for 2 seconds or longer.

2 Shift the jog lever Select "Power Mode" and press to confirm.

3 Shift the jog lever Select "Power Save" and press to confirm. The "3-color notification LED" on the main unit goes off.

To stop the setting on the way

Press the DISPLAY button or the x button for at least 2 seconds.

To turn on the "3-color notification LED" Select "Normal" in step 3 above.

Various settings (continued)

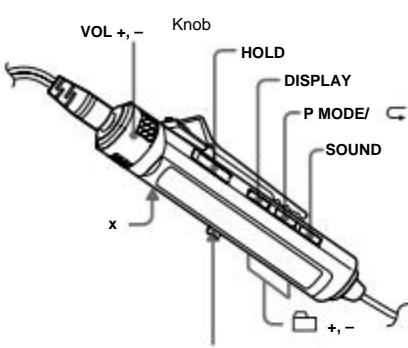

Jog Lever (. U / ENT >)

Prevent erroneous operation (Hold function)

1 Move the HOLD of the remote controller in the direction of- and in the main unit in the direction of . If you move the HOLD switch on the remote control, the operation buttons on the remote control will change to the main unit. If you move the HOLD switch, the operation buttons on the main unit will not work.

To release HOLD

Move the HOLD switch in the opposite direction of the arrow.

Suppress skipping G-PROTECTION

G-PROTECTION is a sound skip guard function developed assuming the impact of jogging. It is even more resistant to skipping than conventional skipping guards.

please note

The sound may skip in the following cases. • When a strong impact is continuously applied • When listening to a scratched or dirty MD

About B power supply

When to replace rechargeable batteries / batteries

During use, you will be notified by the battery level display on the display window of the remote control or by the "3-color notification LED" display on the main unit.

Remote control display window
 The remaining amount is low.
 The battery is dead.
 There is no remaining amount. The "LOW BATT" display on the remote control flashes and the power turns off.

"3-color notification LED" display on the main unit

LED lighting The battery level is sufficient. •

LED flashes slowly The battery is low. •

LED flashes fast There is no battery left. Shiba •

When it is easy, the LED turns off and the power turns off .

please note

• Even if you insert a rechargeable battery that is not 100% charged, the remaining amount display may be all lit, but if the charge amount (charging time) is low, the duration will be shorter. • When fast-rewinding / fast-forwarding or using in a place where the temperature is extremely low, the remaining amount may be displayed more or less.

Battery life 1) (JEITA2)				
use battery	SP	LP2	LP4	
		Stereo Stereo(Normal)		stereo
Rechargeable nickel-metal hydride battery NH-14WM (A) (at 100% charge)	About 33 hours	About 44 hours	About 51 hours	About
Alkaline batteries LR6(SG3)	About 57 hours	About 67 hours	About 80 hours	About
Combined use of rechargeable nickel-metal hydride batteries and alkaline batteries 3)	About 92 hours	About 113 hours	About 131 hours	About

1) This is the value when the power save function is ON.
2) Measured values according to JEITA (Japan Electronics and Information Technology Industries Association) standards (using Sony MDW series minidisks).
3) Measured with Sony alkaline battery LR6 (SG) made in Japan .

please note

Battery life may be shorter depending on ambient temperature, usage conditions, and battery type.

Use by connecting to an outlet (household power supply)

If you connect the AC power adapter to the charging stand and place the main unit on it, you can use it without rechargeable batteries or dry batteries.

B Other

Precautions for use

Do not disassemble It is dangerous if the laser beam used in the MiniDisc player hits your eyes.

Do not touch the lens. If the lens becomes dirty, skipping may occur or playback may not be possible. Also, to prevent dust from getting on, do not open the lid except for inserting and removing the disc.

AC power adapter (for the included charging stand only) • Use the included AC power adapter / separately sold AC power adapter AC-E30L for this product . Using a product other than the above may cause a malfunction.

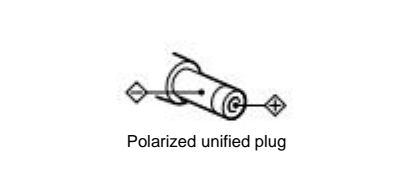

• Connect the AC power adapter to a power outlet that is easily accessible, and disconnect it immediately if something goes wrong. • Please note the following points when using the AC power adapter. — Do not place the unit in a small space such as a bookshelf or a built-in cabinet. — To avoid the risk of fire or electric shock, do not use in wet or damp places. Also, do not place anything containing water such as a vase on the machine.

Charging • The included charging stand is for this unit only. Other devices cannot be charged. • With the attached charging stand, except for the specified batteries

Do not charge. • Charge the battery in a place between + 5 ° C and + 40 ° C • While charging, the charging station and rechargeable battery will get hot, but there is no danger. • Rechargeable batteries that have not been used for a long time or at the time of purchase may have a short duration. This is due to the characteristics of the battery, and it will be fully charged after repeated charging and discharging several times. • If the rechargeable battery is fully charged and the usable time is reduced to about half of the normal time, replace it with a new rechargeable battery. • Charge the main unit as soon as possible after charging. • Remove it from the cable and disconnect the AC power adapter from the concept. Leaving it plugged in for a long time may reduce battery performance.

Disposal of rechargeable batteries in Japan Nickel-metal hydride batteries can be recycled. If you no longer need a nickel-metal hydride battery, attach insulating tape such as cellophane tape to the metal part and take it to a recycling shop.

Please refer to the website of the Battery Association of Japan: http://www.baj.or.jp/ for information on collection / recycling and recycling cooperation stores for rechargeable batteries .

About handling

• Do not drop or give a strong shock. It may cause a malfunction. • Do not pull strongly on the remote control or headphone cord. • Do not place in the following places.

— Very hot places — Near direct sunlight or heating appliances — Inside a car with closed windows (especially in summer) — Humid places such as bathrooms — Magnets, speakers, TVs, etc. Near the dust — dusty areas

Temperature rise The temperature of the main unit may rise during charging or when it is used for a long time, but this is not a malfunction.

Operation sound This unit uses a power-saving operation method. Therefore, there is an intermittent operating noise during operation, but this is not a malfunction.

About the handling of minidisc
• The minidisc itself is stored in a cartridge It is easy to handle without worrying about dust and fingerprints. However, dirt or warpage of the cartridge may cause malfunction. Please note the following so that you can enjoy beautiful sounds forever. — Do not touch the minidisc directly. Do not open the shutter by hand. If you force it open, it will break.

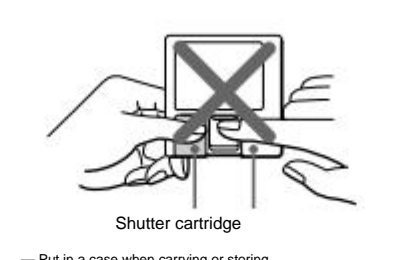

About the location

Do not place in places with high temperature or high humidity such as in direct sunlight. Also, do not leave the disc in a place where sand may get inside, such as a sandy beach. — Clean regularly Wipe off any dust or debris on the surface of the cartridge with a dry cloth.

• Do not put the label attached to the disc in any position other than the specified position. Be sure to attach it firmly according to the indentation for the label.

Headphones • If you turn up the volume of the included headphones too high, the sound will leak out. Be careful not to turn up the volume too much and disturb the people around you. It is easy to turn up the volume in a noisy place, but when listening with headphones, use a volume that is high enough to be called out and answered at any time.

• If you feel that the supplied headphones do not fit your skin, stop using them as soon as possible and consult a doctor or customer service center. • To clean the earpiece, remove the earpiece from the headphones and wash your hands with a diluted neutral detergent. After cleaning, wipe off the water well before use. • The earpiece may deteriorate due to long-term use and storage.

About the remote control • The attached remote control is for this unit only. Also, you cannot operate this unit with the remote control that comes with other models. • If you lose the clip on the remote control, contact the store where you purchased the product or the service counter near you in the attached "Sony Consultation Desk Information".

About the dry battery case The attached dry battery case is for this unit only.

In the unlikely event that the product breaks down, do not open the inside and contact the store where you purchased the product or a Sony service center. (If a failure occurs while the disc is in the main unit, we recommend that you consult with us with the disk inserted for early resolution of the cause of the failure.)

Care

When the surface becomes dirty If the surface becomes dirty, wipe it gently with a soft cloth dampened with water, and then wipe it with a cloth. Do not use thinner, benzine, alcohol, etc. as they will damage the surface.

Cleaning the headphone and remote control plugs To ensure a good sound, occasionally wipe the plugs with a soft cloth to keep them clean. If it is dirty, it may cause noise and sound interruption.

Cleaning the terminals Regularly clean each terminal (such as the charging terminal of the main unit or the terminal of the battery case) with a cotton swab or a soft cloth.

The rechargeable battery or dry battery is exhausted ("LOW BATT" is displayed on the remote controller). b Charge the rechargeable battery or replace the battery with a new one Please replace it with one.

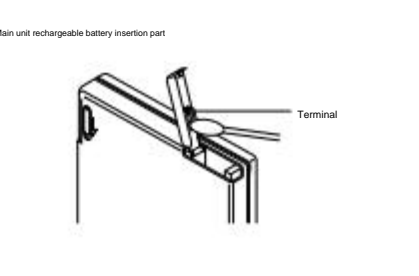

Main unit rechargeable battery insertion port

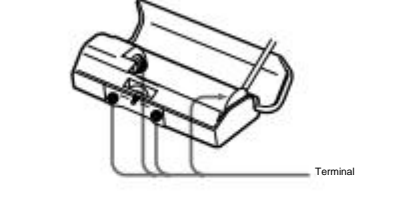

Rechargeable battery (included) / dry battery (sold separately)

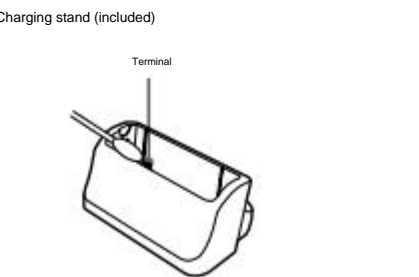
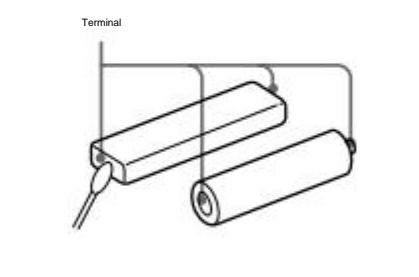

if you thought it was a malfunction

Please check again before contacting the service center. If you have any questions, please contact the customer service center.

unable to charge • The charging terminal of the charging stand is dirty. b Wipe the charging terminal with a dry cloth. • There is no rechargeable battery. b Insert the rechargeable battery.

• The temperature of the charging area is too high; ("Cannot CHG" is displayed on the remote control) or too low. ("SLOW CHG" is displayed on the remote control.) b Charge the battery at a temperature of + 5 ° C to + 40 ° C.

when. Even if the main body is placed on the charging stand, "3-color notification" LED "does not turn on

• There is no rechargeable battery. b Insert the rechargeable battery. • Even if the main unit is placed on the charging stand, the "3-color notification LED" may not turn on immediately. b Place the main unit on the charging stand and after about 3 minutes, The "3-color notification LED" lights up and charging starts.

Do not accept operations • The battery is not inserted properly. b Reinsert the 3 and # terminals of the battery correctly, please give me. • There is no disc inserted ("NO DISC" is displayed on the remote control). b Insert the disc.

• The hold function is working (when you press the operation button on the main unit, "HOLD" is displayed on the remote control.) b Turn the HOLD switch in the opposite direction of the arrow to cancel the hold function. • You pressed a button on the main unit during setting with the remote control. (When you press the button on the main unit, "MENU" is displayed on the remote control). b Use the remote control to end the operation.

• Condensation (water droplets adhere to the inside). b Remove the disc and wait a few hours when. • The rechargeable battery or dry battery is exhausted ("LOW BATT" is displayed on the remote controller). b Charge the rechargeable battery or replace the battery with a new one Please replace it with one.

• There is an unrecorded disc ("BLANK DISC" is displayed on the remote control). b Insert the recorded disc.

• The disk is damaged (to the remote control) "READ ERR" or "TOC ERR" is displayed). b Reinsert the disc. If the display still appears, replace it with another disk.

— During use, it receives strong noise due to shock, excessive static electricity, abnormal voltage of the source voltage due to lightning strike, etc. noise b Follow the procedure below to perform the operation again. 1 Remove all power supplies. 2 Leave it for about 30 seconds. 3 Connect the power supply.

There is no sound from the headphones • Headphones are not plugged in firmly. b Insert it firmly into the i jack

— b Insert the headphones firmly into the remote control Please. • The AVLS function is working. b Cancel AVLS. For details, see "Suppressing sound leakage and making the sound easy on the ears."

Normal playback is not possible • Repeat playback was specified. b Press the P MODE / button on the remote control for 2 seconds or longer. Press and hold to turn off the (repeat) display before starting playback.

Cannot play from the first song on the disc • When played last time, it stopped in the middle of the disc. b Open the lid or use the remote control while stopped Press and hold the jog lever for at least 2 seconds . You can play from the first song.

Sound is interrupted during playback • Placed in a place with a lot of vibration. b Use in a place with little vibration. • If the recording time of one song such as narration or intro is extremely short, the sound may be interrupted.

Noisy • Placed near a strong magnetic object such as a TV. b Keep away from TVs.

I hear a momentary noise • Sound recorded in stereo with LP4 (4x mode) Playing b When playing back LP4 stereo recorded sound Due to the characteristics of the compression method, you may hear momentary noise on rare occasions. • If the headphone cord rubs against clothes, it may make a noise, but this is not a malfunction.

"3-color notification LED" and the display window of the remote control do not come on during playback

• The power save function is working. b When the power save function is working, the display window will be attached if you operate it with the remote control, but the display window will not be attached even if you operate it with the main unit. (However, it is attached only when the GROUP button on the main unit is pressed.)

Group function does not work • Using a disk that is not grouped There is. b Group Use the set disk Please.

Bookmark playback is not possible (on the remote control) jNO "MARK" is displayed) • You tried to select bookmark playback without bookmarking. b Please bookmark. For details, see "How to add a book mark" in "Select and listen to only your favorite songs."

Rotary Commander RM-WMC1 MD Label Printer MZP-1 IC memory, repeat learning. MD controller RPT-M1

The following models cannot be used in combination with this unit.

This machine is a licensed product based on US and foreign patents of Dolby Laboratories.

eco This explanation is 100% chlorine-free ink and uses eco-friendly ink.

Main Specifications

form

Minidisc digital audio system Playback reading method Non-contact optical reading (using semiconductor laser) laser

GaAlAs MQW diode, λ = 790 nm Rotation speed approx. 300 rpm to 2,700 rpm Error correction method ACIRC (Advanced Cross Interleaved Reed-Solomon Code) Sampling frequency 44.1 kHz

coding ATRAC (Adaptive Transform Acoustic Coding) ATRAC3 — LP2 / LP4 modulation

method EFM Number of channels Stereo 2 channels Monoaural 1 channel Frequency characteristics 20 to 20,000 Hz ± 3 dB Output terminal Headphones: Stereo mini jack Maximum output 5 mW × 5 mW * (16 Ω)

Rechargeable battery (included): NH-14WM (A), 1.2 V, 1350 mAh (MIN), Ni-MH) 1 Alkaline battery (AA) 1 External power jack (Charging stand) Rated DC 3 V

AC power adapter (for charging stand, included), AC100V, 50 / 60Hz Battery duration See "When to replace rechargeable batteries / batteries". Body dimensions approx. 73.4 x 80.6 x 15.7 mm (width / height / depth, excluding protrusions) Maximum external dimensions * approx. 75.6 x 81.2 x 18.7 mm (width / height / depth)

Weight approx. 78g (main unit only) approx. 105g (including rechargeable battery) *Measured according to JEITA (Japan Electronics and Information Technology Industries Association) standards The value.

Please note that the specifications and appearance of this machine are subject to change without notice for improvement.

This machine is a licensed product based on US and foreign patents of Dolby Laboratories.

Optional accessories AC Power Adapter AC-E30L Rechargeable NiMH Battery NH-14WM Stereo Headphones * MDR-EB88SP Active speaker SRS-ZS10, MDR-EX-T1SL, MDR-Q55L, etc. SRS-Z30, etc.

• When connecting headphones to the I-jack of the main unit Also, when connecting to a remote control, please purchase a stereo mini plug. You cannot use the micro plug.

The following models cannot be used in combination with this unit. Rotary Commander RM-WMC1 MD Label Printer MZP-1 IC memory, repeat learning. MD controller RPT-M1

name — Model — Consultation content: As detailed as possible — Date of purchase

For inquiries If you have any questions about this machine, have technical questions, or have any questions regarding any problems, please contact the following. • The product category of this unit is [Audio] { Walkman } • When making inquiries, please let us know the following.

• http://www.sony.co.jp/SonyDrive/ お客様ご相談センター •ナビダイヤル ☎0570-00-3311 (全国どこからでも無料通話料がかかります) •携帯電話・PHSでの利用は 03-5448-3311 (ナビダイヤルがご利用できない場合はこちらをご利用ください) •FAX 0466-31-2595 受付時間：月～金 9:00～20:00 土・日 祝日 9:00～17:00 お電話は自動音声化音にてお受けしています。

ソニー株式会社 〒141-0001 東京都品川区北品川 6-7-35

Warranty and after-sales service

Warranty

• This product comes with a warranty. So, please pick it up at the store where you purchased it. • Please fill in the required items and check the contents, and save it in a safe place. • The warranty period is one year from the date of purchase.

After-sales service • If you are not feeling well, please check first. Please read this manual again to find out. • If you still feel sick, go to service

Please contact the store where you purchased the product or the nearest Sony service counter in the attached "Sony Consultation Counter Information". • Repairs during the warranty period

We will repair it based on the contents of the warranty. Please see the warranty for details. • Repairs after the warranty period will be charged if the function can be maintained by the repair. • Regarding the retention period of parts We retain performance parts for repair of portable minidisc players (parts necessary to maintain the function of the product) for 8 years after the production is discontinued . This parts holding period will be the repairable period. Even after the retention period has expired, repair may be possible depending on the location of the failure, so please contact the store where you purchased the product or the service counter.

Observe safety precautions Please read the following notes carefully. Contains general precautions for the product.

Check regularly Once a year, check that there is no dust accumulated between the plug of the AC power adapter and the concept, and that the product is not used with a malfunction.

Do not use if it breaks down Do not use while driving • Never use headphones, earphones, etc. perform detailed operations, or look at the display screen while driving a car or motorcycle. It may cause a traffic accident.

Should something go wrong 1 Turn off the power 2 Unplug the AC power adapter from the outlet 3 Request repair from the store where you purchased the product or the Sony service counter.

If you hear strange sounds or smells, or if smoke comes out

Failure to follow the precautions below may result in serious injury due to fire or electric shock.

Also, when using while walking, to prevent accidents, traffic around you Please be careful about the road surface condition.

Do not allow water or foreign matter to get inside. Water or foreign matter may cause a fire or electric shock. In the unlikely event that water or foreign matter gets in, turn off the switch immediately. Unplug the AC power adapter from the outlet, and contact the store where you purchased the product or a Sony service center.

Domestic-only machines are not used overseas AC adapters other than world models are for Japan-only use. Please use with an AC 100V power supply. Using different power supply voltages overseas may cause a fire or electric shock.

Do not touch the AC power adapter or charging station with wet hands . It may cause an electric shock.

Do not use a charging station or AC power adapter other than the specified one. Explosion, liquid leakage, overheating, etc. may cause fire, injury or stain on the surrounding area.

Do not touch the AC power adapter or charging station with wet hands . It may cause an electric shock.

Do not use while driving • Never use headphones, earphones, etc. perform detailed operations, or look at the display screen while driving a car or motorcycle. It may cause a traffic accident.

Also, when using while walking, to prevent accidents, traffic around you Please be careful about the road surface condition.

Do not allow water or foreign matter to get inside. Water or foreign matter may cause a fire or electric shock. In the unlikely event that water or foreign matter gets in, turn off the switch immediately. Unplug the AC power adapter from the outlet, and contact the store where you purchased the product or a Sony service center.

Failure to follow the precautions below may result in serious injury due to fire or electric shock.

警告 For your safety

Sony products are designed with due consideration for safety. However, if all electrical products are used improperly, they may cause personal injury due to fire or electric shock, which is dangerous. Be sure to observe the following to prevent accidents.

Observe safety precautions

Please read the following notes carefully. Contains general precautions for the product.

Check regularly

Once a year, check that there is no dust accumulated between the plug of the AC power adapter and the concept, and that the product is not used with a malfunction.

Do not use if it breaks down

If you notice any malfunction or damage to the AC power adapter, charging stand, etc., immediately contact the store where you purchased the product or a Sony service center for repair.

Should something go wrong

If you hear strange sounds or smells, or if smoke comes out

Failure to follow the precautions below may result in serious injury due to fire or electric shock.

Also, when using while walking, to prevent accidents, traffic around you Please be careful about the road surface condition.

Do not allow water or foreign matter to get inside. Water or foreign matter may cause a fire or electric shock. In the unlikely event that water or foreign matter gets in, turn off the switch immediately. Unplug the AC power adapter from the outlet, and contact the store where you purchased the product or a Sony service center.

Domestic-only machines are not used overseas AC adapters other than world models are for Japan-only use. Please use with an AC 100V power supply. Using different power supply voltages overseas may cause a fire or electric shock.

Do not touch the AC power adapter or charging station with wet hands . It may cause an electric shock.

Do not use a charging station or AC power adapter other than the specified one. Explosion, liquid leakage, overheating, etc. may cause fire, injury or stain on the surrounding area.

Do not touch the AC power adapter or charging station with wet hands . It may cause an electric shock.

Do not use while driving • Never use headphones, earphones, etc. perform detailed operations, or look at the display screen while driving a car or motorcycle. It may cause a traffic accident.

Also, when using while walking, to prevent accidents, traffic around you Please be careful about the road surface condition.

Do not allow water or foreign matter to get inside. Water or foreign matter may cause a fire or electric shock. In the unlikely event that water or foreign matter gets in, turn off the switch immediately. Unplug the AC power adapter from the outlet, and contact the store where you purchased the product or a Sony service center.

Failure to follow the precautions below may result in serious injury due to fire or electric shock.

Meaning of warning Display The following is displayed in the instruction manual and product. Please read the text after fully understanding the contents of the display.

Failure to follow the precautions on this label may result in death or serious injury due to fire, electric shock, or explosion.

Failure to follow the precautions on this label may result in death or serious injury due to fire or electric shock.

Failure to follow the precautions on this label may result in injury or damage to nearby household items due to electric shock or other accidents.

Attention symbol

Symbol prohibiting action Symbols that indicate actions

Failure to follow the precautions below may result in serious injury due to fire or electric shock.

Also, when using while walking, to prevent accidents, traffic around you Please be careful about the road surface condition.

Do not allow water or foreign matter to get inside. Water or foreign matter may cause a fire or electric shock. In the unlikely event that water or foreign matter gets in, turn off the switch immediately. Unplug the AC power adapter from the outlet, and contact the store where you purchased the product or a Sony service center.

Domestic-only machines are not used overseas AC adapters other than world models are for Japan-only use. Please use with an AC 100V power supply. Using different power supply voltages overseas may cause a fire or electric shock.

Do not touch the AC power adapter or charging station with wet hands . It may cause an electric shock.

Do not use a charging station or AC power adapter other than the specified one. Explosion, liquid leakage, overheating, etc. may cause fire, injury or stain on the surrounding area.

Do not touch the AC power adapter or charging station with wet hands . It may cause an electric shock.

Do not use while driving • Never use headphones, earphones, etc. perform detailed operations, or look at the display screen while driving a car or motorcycle. It may cause a traffic accident.

Also, when using while walking, to prevent accidents, traffic around you Please be careful about the road surface condition.

Do not allow water or foreign matter to get inside. Water or foreign matter may cause a fire or electric shock. In the unlikely event that water or foreign matter gets in, turn off the switch immediately. Unplug the AC power adapter from the outlet, and contact the store where you purchased the product or a Sony service center.

Failure to follow the precautions below may result in serious injury due to fire or electric shock.

If you do not use the main unit, AC power adapter, or charging stand covered with a futon, the case may be deformed or a fire may occur due to heat buildup.

Do not charge or leave the product near a fire or under the scorching sun. The internal temperature will rise, which may cause a fire or malfunction.

Do not place metal on the charging stand if the terminal of the charging stand is connected to metal, it may short-circuit and generate heat.

Do not carry or store the main unit or battery case with metal. If you carry or store it with metal such as coins or key necklaces, it may cause a short circuit and generate heat.

注意 If you do not follow the precautions below, you may be injured or damage the surrounding household goods.

Do not listen too loudly for a long time if you listen for a long time at a loud volume that stimulates your ears, it may have a bad effect on your hearing. Be especially careful when listening with headphones. Listen at a volume that allows you to be called and answered.

Do not turn up the volume too much from the beginning. Suddenly, a loud noise may be heard and your ears may be damaged. Let's gradually increase the volume . Be especially careful when listening to digital devices with low noise, such as MDs, CDs, and DATs, with headphones.

Do not touch the AC power adapter, charging stand, or product while the power is on. If the skin is left in contact for a long time, it may cause low-temperature burns.

Battery Safety Precautions Liquid Leakage Explosion Fever Ignition To avoid serious injury or blindness due to accidental ingestion Please be sure to observe the following.

If the rechargeable battery or dry battery leaks, the rechargeable battery, or if the dry battery leaks, do not touch the liquid with your bare hands . Please consult. If the liquid gets into your eyes, it may cause blindness. Do not rub your eyes. Immediately wash your eyes with clean water such as tap water and see a doctor immediately. If the liquid gets on your body or clothes, it can cause burns and burns, so wash it off immediately with clean water and consult a doctor if you have any symptoms of skin irritation or injury.

About rechargeable batteries