

SONY

3-238-528-12(1)

Portable MiniDisc Player

Operating Instructions



Printed on 100% recycled paper using VOC (Volatile Organic Compound)-free vegetable oil based ink.

WARNING

To prevent fire or shock hazard, do not expose the unit to rain or moisture.

To prevent fire, do not cover the ventilation of the apparatus with newspapers, table cloths, curtains, etc. And don't place lighted candles on the apparatus.

To prevent fire or shock hazard, do not place objects filled with liquids, such as vases, on the apparatus.

Certain situations may require disposal of the battery used to power this product. Please consult with your local authority.

CAUTION The use of optical instruments with this product will increase eye hazard.

CAUTION - INVISIBLE LASER RADIATION WHEN OPEN

DO NOT STARE INTO BEAM OR VIEW DIRECTLY WITH OPTICAL INSTRUMENTS

Information

IN NO EVENT SHALL SELLER BE LIABLE FOR ANY DIRECT, INCIDENTAL OR CONSEQUENTIAL DAMAGES OF ANY NATURE, OR LOSSES OR EXPENSES RESULTING FROM ANY DEFECTIVE PRODUCT OR THE USE OF ANY PRODUCT.

Getting started

Charge the supplied rechargeable battery before using it for the first time.

1 Insert the rechargeable battery.

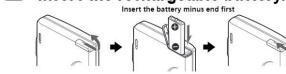

2 Charge the rechargeable battery.

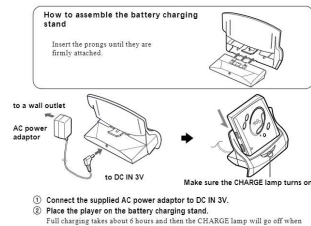

- 1 Connect the supplied AC power adaptor to DC IN 3V.
- 2 Place the player on the battery charging stand.

Do not operate the player when you place it in the battery charging stand or during charging. If you do so, it may cause the player to malfunction or prevent the battery from charging.



Insert a LR6 (size AA) alkaline dry battery. To operate the player for the longest possible time, use the dry battery together with a fully rechargeable battery.

3 Make connections and unlock the HOLD control.

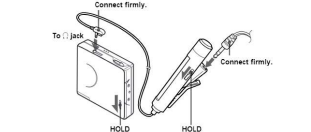

How to use the control on the remote control: Playback: Turn the control towards [REW] while the player is stopped. FF: Turn and hold the control towards [FF] during playback. RM: Turn and hold the control towards [RM] during playback. AMS: Turn the control towards [AMS] or [FWD] during playback.

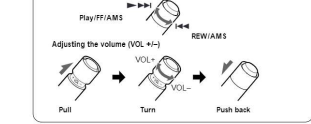

Playing an MD

1 Insert an MD.

- 1 Slide OPEN to open the lid.
- 2 Insert an MD.
- 3 Close the lid.



Insert an MD with the label side facing up, pushing the MD to the direction of the arrow in the illustration.

2 Play an MD.

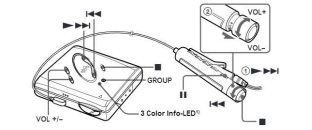

- 1 Turn the control towards [REW] on the remote control (press [REW] on the player) to play the disc.
- 2 Pull and turn VOL +/- on the remote control (or press VOL +/- on the player) to adjust the volume.
- 3 Turn the control towards [REW] on the remote control (or press [REW] on the player) to stop play.
- 4 Turn the control towards [FF] on the remote control (or press [FF] on the player) to resume play.
- 5 Turn the control towards [FF] on the remote control (or press [FF] on the player) to stop play.
- 6 Turn the control towards [FF] on the remote control (or press [FF] on the player) to stop play.
- 7 Turn the control towards [FF] on the remote control (or press [FF] on the player) to stop play.
- 8 Turn the control towards [FF] on the remote control (or press [FF] on the player) to stop play.
- 9 Turn the control towards [FF] on the remote control (or press [FF] on the player) to stop play.
- 10 Turn the control towards [FF] on the remote control (or press [FF] on the player) to stop play.
- 11 Turn the control towards [FF] on the remote control (or press [FF] on the player) to stop play.
- 12 Turn the control towards [FF] on the remote control (or press [FF] on the player) to stop play.
- 13 Turn the control towards [FF] on the remote control (or press [FF] on the player) to stop play.
- 14 Turn the control towards [FF] on the remote control (or press [FF] on the player) to stop play.
- 15 Turn the control towards [FF] on the remote control (or press [FF] on the player) to stop play.
- 16 Turn the control towards [FF] on the remote control (or press [FF] on the player) to stop play.
- 17 Turn the control towards [FF] on the remote control (or press [FF] on the player) to stop play.
- 18 Turn the control towards [FF] on the remote control (or press [FF] on the player) to stop play.
- 19 Turn the control towards [FF] on the remote control (or press [FF] on the player) to stop play.
- 20 Turn the control towards [FF] on the remote control (or press [FF] on the player) to stop play.
- 21 Turn the control towards [FF] on the remote control (or press [FF] on the player) to stop play.
- 22 Turn the control towards [FF] on the remote control (or press [FF] on the player) to stop play.
- 23 Turn the control towards [FF] on the remote control (or press [FF] on the player) to stop play.
- 24 Turn the control towards [FF] on the remote control (or press [FF] on the player) to stop play.
- 25 Turn the control towards [FF] on the remote control (or press [FF] on the player) to stop play.
- 26 Turn the control towards [FF] on the remote control (or press [FF] on the player) to stop play.
- 27 Turn the control towards [FF] on the remote control (or press [FF] on the player) to stop play.
- 28 Turn the control towards [FF] on the remote control (or press [FF] on the player) to stop play.
- 29 Turn the control towards [FF] on the remote control (or press [FF] on the player) to stop play.
- 30 Turn the control towards [FF] on the remote control (or press [FF] on the player) to stop play.
- 31 Turn the control towards [FF] on the remote control (or press [FF] on the player) to stop play.
- 32 Turn the control towards [FF] on the remote control (or press [FF] on the player) to stop play.
- 33 Turn the control towards [FF] on the remote control (or press [FF] on the player) to stop play.
- 34 Turn the control towards [FF] on the remote control (or press [FF] on the player) to stop play.
- 35 Turn the control towards [FF] on the remote control (or press [FF] on the player) to stop play.
- 36 Turn the control towards [FF] on the remote control (or press [FF] on the player) to stop play.
- 37 Turn the control towards [FF] on the remote control (or press [FF] on the player) to stop play.
- 38 Turn the control towards [FF] on the remote control (or press [FF] on the player) to stop play.
- 39 Turn the control towards [FF] on the remote control (or press [FF] on the player) to stop play.
- 40 Turn the control towards [FF] on the remote control (or press [FF] on the player) to stop play.
- 41 Turn the control towards [FF] on the remote control (or press [FF] on the player) to stop play.
- 42 Turn the control towards [FF] on the remote control (or press [FF] on the player) to stop play.
- 43 Turn the control towards [FF] on the remote control (or press [FF] on the player) to stop play.
- 44 Turn the control towards [FF] on the remote control (or press [FF] on the player) to stop play.
- 45 Turn the control towards [FF] on the remote control (or press [FF] on the player) to stop play.
- 46 Turn the control towards [FF] on the remote control (or press [FF] on the player) to stop play.
- 47 Turn the control towards [FF] on the remote control (or press [FF] on the player) to stop play.
- 48 Turn the control towards [FF] on the remote control (or press [FF] on the player) to stop play.
- 49 Turn the control towards [FF] on the remote control (or press [FF] on the player) to stop play.
- 50 Turn the control towards [FF] on the remote control (or press [FF] on the player) to stop play.
- 51 Turn the control towards [FF] on the remote control (or press [FF] on the player) to stop play.
- 52 Turn the control towards [FF] on the remote control (or press [FF] on the player) to stop play.
- 53 Turn the control towards [FF] on the remote control (or press [FF] on the player) to stop play.
- 54 Turn the control towards [FF] on the remote control (or press [FF] on the player) to stop play.
- 55 Turn the control towards [FF] on the remote control (or press [FF] on the player) to stop play.
- 56 Turn the control towards [FF] on the remote control (or press [FF] on the player) to stop play.
- 57 Turn the control towards [FF] on the remote control (or press [FF] on the player) to stop play.
- 58 Turn the control towards [FF] on the remote control (or press [FF] on the player) to stop play.
- 59 Turn the control towards [FF] on the remote control (or press [FF] on the player) to stop play.
- 60 Turn the control towards [FF] on the remote control (or press [FF] on the player) to stop play.
- 61 Turn the control towards [FF] on the remote control (or press [FF] on the player) to stop play.
- 62 Turn the control towards [FF] on the remote control (or press [FF] on the player) to stop play.
- 63 Turn the control towards [FF] on the remote control (or press [FF] on the player) to stop play.
- 64 Turn the control towards [FF] on the remote control (or press [FF] on the player) to stop play.
- 65 Turn the control towards [FF] on the remote control (or press [FF] on the player) to stop play.
- 66 Turn the control towards [FF] on the remote control (or press [FF] on the player) to stop play.
- 67 Turn the control towards [FF] on the remote control (or press [FF] on the player) to stop play.
- 68 Turn the control towards [FF] on the remote control (or press [FF] on the player) to stop play.
- 69 Turn the control towards [FF] on the remote control (or press [FF] on the player) to stop play.
- 70 Turn the control towards [FF] on the remote control (or press [FF] on the player) to stop play.
- 71 Turn the control towards [FF] on the remote control (or press [FF] on the player) to stop play.
- 72 Turn the control towards [FF] on the remote control (or press [FF] on the player) to stop play.
- 73 Turn the control towards [FF] on the remote control (or press [FF] on the player) to stop play.
- 74 Turn the control towards [FF] on the remote control (or press [FF] on the player) to stop play.
- 75 Turn the control towards [FF] on the remote control (or press [FF] on the player) to stop play.
- 76 Turn the control towards [FF] on the remote control (or press [FF] on the player) to stop play.
- 77 Turn the control towards [FF] on the remote control (or press [FF] on the player) to stop play.
- 78 Turn the control towards [FF] on the remote control (or press [FF] on the player) to stop play.
- 79 Turn the control towards [FF] on the remote control (or press [FF] on the player) to stop play.
- 80 Turn the control towards [FF] on the remote control (or press [FF] on the player) to stop play.
- 81 Turn the control towards [FF] on the remote control (or press [FF] on the player) to stop play.
- 82 Turn the control towards [FF] on the remote control (or press [FF] on the player) to stop play.
- 83 Turn the control towards [FF] on the remote control (or press [FF] on the player) to stop play.
- 84 Turn the control towards [FF] on the remote control (or press [FF] on the player) to stop play.
- 85 Turn the control towards [FF] on the remote control (or press [FF] on the player) to stop play.
- 86 Turn the control towards [FF] on the remote control (or press [FF] on the player) to stop play.
- 87 Turn the control towards [FF] on the remote control (or press [FF] on the player) to stop play.
- 88 Turn the control towards [FF] on the remote control (or press [FF] on the player) to stop play.
- 89 Turn the control towards [FF] on the remote control (or press [FF] on the player) to stop play.
- 90 Turn the control towards [FF] on the remote control (or press [FF] on the player) to stop play.
- 91 Turn the control towards [FF] on the remote control (or press [FF] on the player) to stop play.
- 92 Turn the control towards [FF] on the remote control (or press [FF] on the player) to stop play.
- 93 Turn the control towards [FF] on the remote control (or press [FF] on the player) to stop play.
- 94 Turn the control towards [FF] on the remote control (or press [FF] on the player) to stop play.
- 95 Turn the control towards [FF] on the remote control (or press [FF] on the player) to stop play.
- 96 Turn the control towards [FF] on the remote control (or press [FF] on the player) to stop play.
- 97 Turn the control towards [FF] on the remote control (or press [FF] on the player) to stop play.
- 98 Turn the control towards [FF] on the remote control (or press [FF] on the player) to stop play.
- 99 Turn the control towards [FF] on the remote control (or press [FF] on the player) to stop play.
- 100 Turn the control towards [FF] on the remote control (or press [FF] on the player) to stop play.

- 1 During playback, press [DISPLAY] repeatedly until "PQM" flashes in the display.
- 2 Turn the control repeatedly to select a track number.
- 3 Press RPT. ENT. The track is entered.
- 4 Repeat steps 2 and 3 to select other tracks in the desired sequence.
- 5 Hold down RPT. ENT for 2 seconds or more. The settings are entered and playback starts from the first programmed track.

Note When viewing the disc, make sure to press [REW] and then slide OPEN.

Viewing the display window of the remote control

Track number: [03] Track name: [03:38] or elapsed time of the track

- 1 The player can play the track recorded by 2- or 4-long playing mode (LPI or LPI+). Normal stereo playback, LPI stereo playback, LPI stereo playback or occasional playback is automatically selected to match the audio source.
- 2 The display on the remote control will turn off shortly after you press [REW].

Various ways of playback

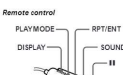

Repeat play

1 Press RPT. ENT on the remote control during playback. "C" appears in the display.

Repeat play indication

003 01:35 [C] [REW]

Searching for a specific track or a position quickly (Quick Search)

You can do two kinds of quick searches.

- 1 Index search - Searching quickly while monitoring the track number or track name (display settings).
- 2 Time search - Searching quickly while monitoring the elapsed time.

This procedure can be done by the remote control.

- 1 During playback, press [DISPLAY] for 2 seconds or more.
- 2 Turn the control repeatedly until "SEARCH" flashes in the display, and press [REW].
- 3 Turn the control repeatedly until "Index" (index search) or "Time" (time search) flashes in the display, and press [REW].
- 4 Press [REW] to pause.
- 5 Turn and hold the control until the desired track number (track name) (index search) or the desired elapsed time (time search) appears in the display.
- 6 Press [REW] to cancel the pause.

Note If you do this procedure while the player is in shuffle play mode, shuffle play starts from the track that you entered.

If the player makes to the first track or the last track on the disc as you are tuning the control in step 5, it will return to the last track or the first track, respectively. (In group mode, the player returns to the first track or the last track in that group, respectively (see "Using the group function").

If you do this procedure while the player is in shuffle play mode, shuffle play starts from the track that you entered.

If the player makes to the first track or the last track on the disc as you are tuning the control in step 5, it will return to the last track or the first track in that group, respectively (see "Using the group function").

If you do this procedure while the player is in shuffle play mode, shuffle play starts from the track that you entered.

If the player makes to the first track or the last track on the disc as you are tuning the control in step 5, it will return to the last track or the first track in that group, respectively (see "Using the group function").

If you do this procedure while the player is in shuffle play mode, shuffle play starts from the track that you entered.

If the player makes to the first track or the last track on the disc as you are tuning the control in step 5, it will return to the last track or the first track in that group, respectively (see "Using the group function").

If you do this procedure while the player is in shuffle play mode, shuffle play starts from the track that you entered.

If the player makes to the first track or the last track on the disc as you are tuning the control in step 5, it will return to the last track or the first track in that group, respectively (see "Using the group function").

If you do this procedure while the player is in shuffle play mode, shuffle play starts from the track that you entered.

If the player makes to the first track or the last track on the disc as you are tuning the control in step 5, it will return to the last track or the first track in that group, respectively (see "Using the group function").

If you do this procedure while the player is in shuffle play mode, shuffle play starts from the track that you entered.

If the player makes to the first track or the last track on the disc as you are tuning the control in step 5, it will return to the last track or the first track in that group, respectively (see "Using the group function").

If you do this procedure while the player is in shuffle play mode, shuffle play starts from the track that you entered.

If the player makes to the first track or the last track on the disc as you are tuning the control in step 5, it will return to the last track or the first track in that group, respectively (see "Using the group function").

If you do this procedure while the player is in shuffle play mode, shuffle play starts from the track that you entered.

If the player makes to the first track or the last track on the disc as you are tuning the control in step 5, it will return to the last track or the first track in that group, respectively (see "Using the group function").

If you do this procedure while the player is in shuffle play mode, shuffle play starts from the track that you entered.

If the player makes to the first track or the last track on the disc as you are tuning the control in step 5, it will return to the last track or the first track in that group, respectively (see "Using the group function").

If you do this procedure while the player is in shuffle play mode, shuffle play starts from the track that you entered.

If the player makes to the first track or the last track on the disc as you are tuning the control in step 5, it will return to the last track or the first track in that group, respectively (see "Using the group function").

If you do this procedure while the player is in shuffle play mode, shuffle play starts from the track that you entered.

If the player makes to the first track or the last track on the disc as you are tuning the control in step 5, it will return to the last track or the first track in that group, respectively (see "Using the group function").

If you do this procedure while the player is in shuffle play mode, shuffle play starts from the track that you entered.

If the player makes to the first track or the last track on the disc as you are tuning the control in step 5, it will return to the last track or the first track in that group, respectively (see "Using the group function").

If you do this procedure while the player is in shuffle play mode, shuffle play starts from the track that you entered.

If the player makes to the first track or the last track on the disc as you are tuning the control in step 5, it will return to the last track or the first track in that group, respectively (see "Using the group function").

If you do this procedure while the player is in shuffle play mode, shuffle play starts from the track that you entered.

If the player makes to the first track or the last track on the disc as you are tuning the control in step 5, it will return to the last track or the first track in that group, respectively (see "Using the group function").

If you do this procedure while the player is in shuffle play mode, shuffle play starts from the track that you entered.

Notes

- 1 All program settings are lost when the lid is opened.
- 2 If no settings are made for 5 minutes while the player is stopped, the settings made up to that point are entered.
- 3 If you have no group mode during program play, the program play is canceled.

Repeat play

You can use this function to repeat playback in normal play, single play, shuffle play, or program play mode.

- 1 Press RPT. ENT on the remote control during playback. "C" appears in the display.

Repeat play indication

003 01:35 [C] [REW]

Searching for a specific track or a position quickly (Quick Search)

You can do two kinds of quick searches.

- 1 Index search - Searching quickly while monitoring the track number or track name (display settings).
- 2 Time search - Searching quickly while monitoring the elapsed time.

This procedure can be done by the remote control.

- 1 During playback, press [DISPLAY] for 2 seconds or more.
- 2 Turn the control repeatedly until "SEARCH" flashes in the display, and press [REW].
- 3 Turn the control repeatedly until "Index" (index search) or "Time" (time search) flashes in the display, and press [REW].
- 4 Press [REW] to pause.
- 5 Turn and hold the control until the desired track number (track name) (index search) or the desired elapsed time (time search) appears in the display.
- 6 Press [REW] to cancel the pause.

Note If you do this procedure while the player is in shuffle play mode, shuffle play starts from the track that you entered.

If the player makes to the first track or the last track on the disc as you are tuning the control in step 5, it will return to the last track or the first track in that group, respectively (see "Using the group function").

If you do this procedure while the player is in shuffle play mode, shuffle play starts from the track that you entered.

If the player makes to the first track or the last track on the disc as you are tuning the control in step 5, it will return to the last track or the first track in that group, respectively (see "Using the group function").

If you do this procedure while the player is in shuffle play mode, shuffle play starts from the track that you entered.

If the player makes to the first track or the last track on the disc as you are tuning the control in step 5, it will return to the last track or the first track in that group, respectively (see "Using the group function").

If you do this procedure while the player is in shuffle play mode, shuffle play starts from the track that you entered.

If the player makes to the first track or the last track on the disc as you are tuning the control in step 5, it will return to the last track or the first track in that group, respectively (see "Using the group function").

If you do this procedure while the player is in shuffle play mode, shuffle play starts from the track that you entered.

If the player makes to the first track or the last track on the disc as you are tuning the control in step 5, it will return to the last track or the first track in that group, respectively (see "Using the group function").

If you do this procedure while the player is in shuffle play mode, shuffle play starts from the track that you entered.

If the player makes to the first track or the last track on the disc as you are tuning the control in step 5, it will return to the last track or the first track in that group, respectively (see "Using the group function").

If you do this procedure while the player is in shuffle play mode, shuffle play starts from the track that you entered.

If the player makes to the first track or the last track on the disc as you are tuning the control in step 5, it will return to the last track or the first track in that group, respectively (see "Using the group function").

If you do this procedure while the player is in shuffle play mode, shuffle play starts from the track that you entered.

If the player makes to the first track or the last track on the disc as you are tuning the control in step 5, it will return to the last track or the first track in that group, respectively (see "Using the group function").

If you do this procedure while the player is in shuffle play mode, shuffle play starts from the track that you entered.

If the player makes to the first track or the last track on the disc as you are tuning the control in step 5, it will return to the last track or the first track in that group, respectively (see "Using the group function").

If you do this procedure while the player is in shuffle play mode, shuffle play starts from the track that you entered.

If the player makes to the first track or the last track on the disc as you are tuning the control in step 5, it will return to the last track or the first track in that group, respectively (see "Using the group function").

If you do this procedure while the player is in shuffle play mode, shuffle play starts from the track that you entered.

If the player makes to the first track or the last track on the disc as you are tuning the control in step 5, it will return to the last track or the first track in that group, respectively (see "Using the group function").

If you do this procedure while the player is in shuffle play mode, shuffle play starts from the track that you entered.

If the player makes to the first track or the last track on the disc as you are tuning the control in step 5, it will return to the last track or the first track in that group, respectively (see "Using the group function").

If you do this procedure while the player is in shuffle play mode, shuffle play starts from the track that you entered.

If the player makes to the first track or the last track on the disc as you are tuning the control in step 5, it will return to the last track or the first track in that group, respectively (see "Using the group function").

If you do this procedure while the player is in shuffle play mode, shuffle play starts from the track that you entered.

If the player makes to the first track or the last track on the disc as you are tuning the control in step 5, it will return to the last track or the first track in that group, respectively (see "Using the group function").

If you do this procedure while the player is in shuffle play mode, shuffle play starts from the track that you entered.

If the player makes to the first track or the last track on the disc as you are tuning the control in step 5, it will return to the last track or the first track in that group, respectively (see "Using the group function").

If you do this procedure while the player is in shuffle play mode, shuffle play starts from the track that you entered.

If the player makes to the first track or the last track on the disc as you are tuning the control in step 5, it will return to the last track or the first track in that group, respectively (see "Using the group function").

If you do this procedure while the player is in shuffle play mode, shuffle play starts from the track that you entered.

If the player makes to the first track or the last track on the disc as you are tuning the control in step 5, it will return to the last track or the first track in that group, respectively (see "Using the group function").

Using the group function

The MZ-E505 can be used with a disc which has group settings.

The group function is useful for playing a great number of tracks, or tracks that have been recorded in MZEP, LPI, LPI+ mode.

Note In group mode, the player treats all tracks without group settings as belonging to the last group on the disc. The last group is indicated in the display on the player as "Group --". Within a group, the tracks appear in their order on the disc, not their order within the group.

What is a disc with group settings?

This is a disc with settings that organize tracks into groups, and which allow those groups to be selected.

The MZ-E505 does not support the recording of group settings. Use your MD recorder to record group information, and then use the MZ-E505 for playback.

Note If your recorder has a function for editing disc data, you can use it to register groups. For details, refer to "Registering groups using your minidisc recorder."

Group 1 Group 2 Group 3

Track number Track number Track number

1 2 3 4 5 6 7 8

skip skip skip

When group mode is on:

Group 1 Group 2 Group 3

Track number Track number Track number

1 2 3 4 5 6 7 8

skip skip skip

When there is no group name (Example: AAA)

Group name

Group number

On the remote control

- 1 Insert a disc which has group settings into the player, and then play the disc.
- 2 Press [DISPLAY] for 2 seconds or more.
- 3 Turn the control repeatedly until "GROUP" flashes in the display,

► Other operations (continued)

Remote control

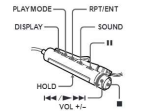

Player



Bottom side of the player



Suppressing the skips of the sound (Q-PROTECTION)

The Q-PROTECTION function was developed to provide a higher level of shock resistance than that of normal players in order to allow the player to be used while jogging.

Note
The playback sound may skip if:
— the player receives stronger continuous shock
— a dirty or scratched MiniDisc is inserted.

Protecting your hearing (AVLS)

AVLS (Automatic Volume Limiter System) function keeps down the maximum volume to protect your ears.

On the remote control

- 1 During playback, press DISPLAY for 2 seconds or more.
- 2 Turn the control repeatedly until "OPTION" flashes in the display and press ■.
- 3 Turn the control repeatedly until "BEEP" flashes in the display and press ■.
- 4 Turn the control repeatedly until "AVLS ON" flashes in the display and press ■. "AVLS ON" appears in the display.

On the player

- 1 During playback, slide HOLD towards ■.
- 2 While pressing VOL —, slide HOLD in the opposite direction.

To cancel the AVLS function
On the remote control, select "AVLS OFF" in step 1.
On the player, during playback, slide HOLD in the direction of ■, and then while pressing VOL —, slide HOLD in the opposite direction.

Turning off the beep sound

You can turn off the beep sound of the remote control in the headphones / earphones. This procedure can be done by the remote control.

- 1 Press DISPLAY for 2 seconds or more.
- 2 Turn the control repeatedly until "OPTION" flashes in the display and press ■.
- 3 Turn the control repeatedly until "BEEP" flashes in the display and press ■.
- 4 Turn the control repeatedly until "BEEP OFF" flashes in the display and press ■.

To cancel the setting
Select "BEEP ON" and press ■ in step 4.

Locking the controls (HOLD)

- 1 Slide HOLD on the remote control in the direction of the ➡ to lock the controls of the remote control and slide HOLD on the player in the direction of the ➡ to lock the controls of the player.
- To unlock the controls
Slide HOLD to the opposite directions of the arrows.

Preserving battery power (Power Save Mode)

You can reduce power consumption and extend the operating life of the battery by turning off the LED during all times, regardless of the operating conditions. This procedure can be done by the remote control.

- 1 Press DISPLAY for 2 seconds or more.
- 2 Turn the control repeatedly until "OPTION" flashes in the display, and then press ■.
- 3 Turn the control repeatedly until "PowerSave" flashes in the display, and then press ■.
- 4 Turn the control repeatedly until "P-Save ON" flashes in the display, and then press ■.

To cancel the setting
Select "P-Save OFF" and press ■ in step 4.

► Power sources

When to replace or recharge the battery

You can check the battery condition through the battery indicator on the remote control and the LED on the player while using the player.

- Indicator on the remote control
- Battery power decreasing
 - Weak battery
 - The battery has given out. "LOW BATT" flashes in the display as the remote control, and the power goes off.

- Indicator of the LED on the player
- The LED lights up. There is sufficient battery power.
 - The LED flashes slowly. Battery power decreasing.
 - The LED flashes quickly. The battery is low. The LED will once turn off and the supply of power will stop.

Notes
• The battery indicator may show the battery to be fully charged even when it is not. Charging the battery shorter than the prescribed time will result in a shorter operating time on the player.
• The battery indicator will show a low charge during forward or backward operation or when the operating temperature is extremely low.

Battery life* (Unit: Approx. hours) (B/T/A)*

Batteries	SP Items	LP4 (nominal)	Status	Score
Ni-MH rechargeable battery: NH14WM(A)*	33	37	43	
LR6 (SG) Sony Alkaline dry battery**	49	54	64	
LR6 (SGV) and NH14WM(A)*	87	97	120	

* Measured with the power save function on (see "Preserving battery power" in 6).
* Measured in accordance with the IEC61874 (Japan Electronic and Information Technology Industries Association standard (using a Sony MDW) when battery is used).

** With a fully-charged battery.
* This model is not compatible with "EAMENA" alkaline dry battery (produced in Japan).

Note
The battery operation may be shorter than that specified, depending on the operating conditions, the temperature of the location, and the type of battery being used.

► Additional information

Precautions

On safety

- Make sure to keep the player in the supplied carrying pouch. If the terminals on the player, battery charging stand, or battery case are accidentally brought into contact with a metallic object, they may short-circuit and begin to heat up.
- Keep the terminals on the player or on the battery case away from sensitive objects or surfaces. Such contact may short-circuit the terminals and cause dangerous heat.
- When carrying the player with you, always keep the battery case attached to the player and the player in the supplied carrying pouch.
- First may build up on the player if it is used for an extended period of time. This, however, is not a malfunction.

- On mechanical noise
- The player emits mechanical noise while operating, which is caused by the power-saving systems of the player. This is not a malfunction.

- On installation
- Never use the player where it will be subjected to extremes of light, temperature, moisture or vibration.
 - Never wrap the player in anything when it is being used with the AC power adaptor. Heat build-up in the player may cause malfunction or injury.

- On the remote control
- The supplied remote control is designed for use with the MD-E301 only. Note also that the player cannot be controlled by remote control for other models.

- On the MiniDisc cartridge
- Do not touch the internal disc directly. Forcing the shutter open may damage the internal disc.
 - When transporting a MiniDisc, keep it in its case.
 - Do not place the cartridge where it will be subjected to light, temperature, moisture or dust.
 - Do not put the label outside of the specified area on the MD. Make sure the label is placed within the reserved space on this disc.

- On the headphones/earphones
- Do not use headphones / earphones while driving, cycling, or operating any motorized vehicle. This may lead to a traffic accident and is illegal in many areas. Items should be potentially dangerous to play your player at high volumes while walking, especially at pedestrian crossings. You should exercise extreme caution or discontinue using the player in potentially hazardous situations.
 - If you experience an allergic reaction to the supplied headphones / earphones, stop using them at once and consult a doctor or a busy service center.

Preventing hearing damage

Avoid using headphones / earphones at high volumes. Hearing experts advise against continuous, loud listening. If you experience a ringing in your ears, reduce the volume or discontinue use.

Caring for others

Keep the volume at a moderate level. This will allow you to hear outside sounds and to be considerate of the people around you.

On the battery case

The supplied battery case is designed for use with the MD-E301 only.

On cleaning

- After wiping the player casing with a soft cloth lightly moistened with water, wipe it again with a dry cloth. Do not use any type of abrasive pad, cleaning powder or solvent such as alcohol or benzene in any way near the finish on the casing.
- Wipe the disc cartridge with a dry cloth to remove dust.
- Dust on the lens may prevent the unit from operating properly. Be sure to clean the disc compartment lid after inserting or ejecting an MD.

- To maintain good sound quality, use a soft cloth to clean the plugs of the headphones / earphones and remote control. A dirty plug may cause noise or intermittent breaks in the sound.
- Clean the terminals periodically with a cotton swab or a soft cloth as described.

- Rechargeable battery compartment
- Terminal

- Dry battery case
- Terminal

- Rechargeable battery (supplied)/ Dry battery (not supplied)
- Terminal

- Battery charging stand
- Terminal

- Bottom side of the player
- Terminal

- Polarity of the plug
- Position the player with the + and - poles aligned correctly.
 - If a battery lead should develop, carefully and thoroughly wipe away the battery fluid in the battery compartment before inserting a new battery.
 - If you will not use the player for a long time, be sure to disconnect the power supply (AC power adaptor, dry battery, rechargeable battery, or battery charging stand). When disconnecting the AC power adaptor from the electrical outlet, grasp the adaptor plug itself; never pull the cord.

- On the AC power adaptor (for the supplied battery charging stand)
- For the use of your locale. Use the supplied AC power adaptor. Do not use any other AC power adaptor since it may cause the player to malfunction.

- On the headphones/earphones
- Do not use headphones / earphones while driving, cycling, or operating any motorized vehicle. This may lead to a traffic accident and is illegal in many areas. Items should be potentially dangerous to play your player at high volumes while walking, especially at pedestrian crossings. You should exercise extreme caution or discontinue using the player in potentially hazardous situations.
 - If you experience an allergic reaction to the supplied headphones / earphones, stop using them at once and consult a doctor or a busy service center.

Preventing hearing damage

Avoid using headphones / earphones at high volumes. Hearing experts advise against continuous, loud listening. If you experience a ringing in your ears, reduce the volume or discontinue use.

Caring for others

Keep the volume at a moderate level. This will allow you to hear outside sounds and to be considerate of the people around you.

On the battery case

The supplied battery case is designed for use with the MD-E301 only.

On cleaning

- After wiping the player casing with a soft cloth lightly moistened with water, wipe it again with a dry cloth. Do not use any type of abrasive pad, cleaning powder or solvent such as alcohol or benzene in any way near the finish on the casing.
- Wipe the disc cartridge with a dry cloth to remove dust.
- Dust on the lens may prevent the unit from operating properly. Be sure to clean the disc compartment lid after inserting or ejecting an MD.

- To maintain good sound quality, use a soft cloth to clean the plugs of the headphones / earphones and remote control. A dirty plug may cause noise or intermittent breaks in the sound.
- Clean the terminals periodically with a cotton swab or a soft cloth as described.

- Rechargeable battery compartment
- Terminal

- Dry battery case
- Terminal

- Rechargeable battery (supplied)/ Dry battery (not supplied)
- Terminal

- Battery charging stand
- Terminal

- Bottom side of the player
- Terminal

- Polarity of the plug
- Position the player with the + and - poles aligned correctly.
 - If a battery lead should develop, carefully and thoroughly wipe away the battery fluid in the battery compartment before inserting a new battery.
 - If you will not use the player for a long time, be sure to disconnect the power supply (AC power adaptor, dry battery, rechargeable battery, or battery charging stand). When disconnecting the AC power adaptor from the electrical outlet, grasp the adaptor plug itself; never pull the cord.

- On the AC power adaptor (for the supplied battery charging stand)
- For the use of your locale. Use the supplied AC power adaptor. Do not use any other AC power adaptor since it may cause the player to malfunction.

- On the headphones/earphones
- Do not use headphones / earphones while driving, cycling, or operating any motorized vehicle. This may lead to a traffic accident and is illegal in many areas. Items should be potentially dangerous to play your player at high volumes while walking, especially at pedestrian crossings. You should exercise extreme caution or discontinue using the player in potentially hazardous situations.
 - If you experience an allergic reaction to the supplied headphones / earphones, stop using them at once and consult a doctor or a busy service center.

Preventing hearing damage

Avoid using headphones / earphones at high volumes. Hearing experts advise against continuous, loud listening. If you experience a ringing in your ears, reduce the volume or discontinue use.

Caring for others

Keep the volume at a moderate level. This will allow you to hear outside sounds and to be considerate of the people around you.

On the battery case

The supplied battery case is designed for use with the MD-E301 only.

On cleaning

- After wiping the player casing with a soft cloth lightly moistened with water, wipe it again with a dry cloth. Do not use any type of abrasive pad, cleaning powder or solvent such as alcohol or benzene in any way near the finish on the casing.
- Wipe the disc cartridge with a dry cloth to remove dust.
- Dust on the lens may prevent the unit from operating properly. Be sure to clean the disc compartment lid after inserting or ejecting an MD.

Troubleshooting

The player does not work or works poorly.

- You tried to play with no disc in the player ("NO DISC" flashes on the remote control).
 - ➔ Insert an MD.
- The hold function is activated and the controls are locked. (If you press any of the operation buttons on the player, "HOLD" flashes on the remote control.)
 - ➔ Slide HOLD in the opposite direction of the arrow to release the hold function.
- When the remote control is enabled for settings ("MENU" appears on the remote control when a button on the player is pressed).
 - ➔ End the setting procedure using the remote control or disconnect the remote control plug.
- Moisture has condensed inside the player.
 - ➔ Take the MD out and wait for several hours until the moisture has evaporated.
- The rechargeable battery or dry battery is weak ("LOW BATT" flashes on the remote control).
 - ➔ Insert a new battery or recharge the battery.
- The rechargeable battery or dry battery has been installed incorrectly.
 - ➔ Insert the battery with correct polarity.
- An MD with nothing recorded on it is inserted ("BLANK/NO DISC" flashes on the remote control).
 - ➔ Insert a recorded MD.
- The player cannot read the disc. (It's scratched or dirty) ("DNG ERR" flashes on the remote control).
 - ➔ Request or replace the disc.
- While operating, the player received a mechanical shock, too much static, abnormal power voltage caused by lightning etc.
 - ➔ Restart the player as follows:
 - 1 Disconnect the power source.
 - 2 Let the player sit for about 30 seconds.
 - 3 Reconnect the power source.

- The MD does not play normally.
- The player is set to the repeat mode. ("C" is displayed on the remote control).
 - ➔ Press RPT / EXT on the remote control repeatedly until "C" disappears, then start playing.
 - The disc is playing in group mode.
 - ➔ Turn off group mode.

The MD does not play from the first track.

- The disc stopped playing before reaching the last track.
 - ➔ Turn and hold the control towards ➡ for 2 seconds or more to start playing from the first track.
- The disc is playing in group mode.
 - ➔ Turn off group mode and stop playback, then turn and hold the control towards ➡ for 2 seconds or more to start playing from the first track.

The digital sound preset function does not work.

- The digital sound preset function is off.
 - ➔ Press SOUND on the remote control repeatedly to select "SOUND1" or "SOUND2".

The playback sound skips.

- The player is placed where it receives continuous vibrations.
- Place the player at a stable place.
- A very short track may cause sound to skip.

The sound has a lot of static.

- Strong magnetism from a television or other device causing interference.
 - ➔ Move the player away from the source of strong magnetism.

- Noise is momentarily heard.
- The sound was recorded in LP4 stereo mode.
 - ➔ Because of the nature of the compression method used in LP4 mode, noise may be output on very rare occasions during playback of sound recorded in this mode.

The rechargeable battery does not start charging.

- The terminals of the battery charging stand are dirty.
 - ➔ Wipe the terminals with a dry cloth.
- The rechargeable battery is not inserted in the player. (When the player is on the battery charging stand, "NO BATT" appears on the remote control when you press one of the operation buttons in order to check the battery level.)
 - ➔ Insert the rechargeable battery into the player.

The CHARGE lamp does not turn on.

- The rechargeable battery is not inserted in the player.
 - ➔ Insert the rechargeable battery into the player.

The player does not operate properly.

- The player is operating while still placed on the battery charging stand.
 - ➔ Remove the player from the battery charging stand.
- An attempt was made to enter group mode with program play selected.
 - ➔ Change to group mode before selecting program play.

There is no sound output from the headphones/earphones or the sound is too low.

- The headphones / earphones plug is not firmly inserted.
 - ➔ Insert the headphones / earphones plug firmly into the remote control.
- Insert the headphones / earphones plug firmly into the remote control.
- AVLS is on.
 - ➔ Cancel the AVLS function. For more details, see "To cancel the AVLS function" in "Protecting your hearing".

The 3 Color Info-LED does not turn on.

- Power save mode is on.
 - ➔ Turn off power save mode. For more details, see "Preserving battery power".

The group function (group mode/group skip mode) does not function.

- An attempt was made to enter group mode while using a disc that has no group settings.
 - ➔ Use a disc with group settings.
- An attempt was made to enter group mode while playing a track that belongs to no group.
 - ➔ The group function cannot be used while a track that belongs to no group is playing.
- An attempt was made to enter group mode with program play selected.
 - ➔ Change to group mode before selecting program play.

When you rewind/forward, the track does not go back or go forward to the consecutive track.

- Group skip mode is on.
 - ➔ Turn off group skip mode. Group skip mode will be canceled if no operation is performed within 3 seconds. For more details, see "Selecting and playing specific groups".

Specifications

Audio playing system
Main: Digital audio system
User-disc properties
Material: GaAsAl
Wave length: $\lambda = 780 \text{ nm}$
Emission duration: continuous
Laser output: less than 44.4 μW
* This output is the value measured at a distance of 200 mm from the objective lens surface on the optical pick-up block with 1 mm aperture.
Resolution
Approx. 100 lines to 2,700 lines
Error correction
ACC (Adaptive Cross Interleave Reed Solomon Code)
Lamping frequency
4.1 kHz
Coding
ATLAS (Adaptive Transform Acoustic Coding)
ATRA3: LP2, LP4
Modulation system
EFM (Eight to Fourteen Modulation)
Number of channels
2 stereo channels
2 monaural channels
Frequency response
20 Hz to 20 kHz (1 dB)
View and flutter
None
Outputs
Headphones / earphones (stereo mini-jack, maximum output level: 16 Ω , 2 mW, impedance 16 Ω)
Power requirements
None
Battery
Nickel metal hydride rechargeable battery
Our MD-E301/MDA (supplied): 1.2V, 1,050 mAh
Our LED (non AA) battery (not supplied)
Battery charging stand
AC power adaptor: DC 3V, AC 100V, 50/60Hz
Battery operating time
See "When to replace or recharge the battery"

Dimensions
Approx. 115 (W) x 17.6 (H) x 17.6 (D) mm (W x H x D)
Net weight: 170 g (with the player only)
Supplied accessories
Headphones / earphones with a remote control (1)
Battery charging stand (1)
AC power adaptor (for the supplied battery charging stand) (1)
Rechargeable battery (1)
Rechargeable battery (carrying case) (1)
Dry battery (case) (1)
Carrying pouch (1)

US and foreign patents licensed from Dolby Laboratories.

Optional accessories

NH14WM (Nickel metal hydride rechargeable battery)
MDR series stereo headphones / earphones
3RS series Active Speakers
* Whether you should plug the headphones / earphones directly to the jack on the main unit, or use only headphones / earphones with stereo mini-plugs. Headphones / earphones with a microplug cannot be used.

Your dealer may not handle some of the above listed accessories. Please ask the dealer for details information about the accessories in your country.

Parts and controls

The Player

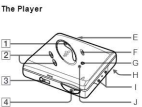

- 1 Headphones / earphones
- 2 Stereo mini-plug
- 3 M (mute) button
- 4 AVLS (Automatic Volume Limiter System) button
- 5 SOUND button
- 6 RPT (Repeat) button
- 7 EXT (Eject) button
- 8 HOLD (Locking the control) switch
- 9 VOL+ (Volume Up) button
- 10 VOL- (Volume Down) button
- 11 DC IN 3V jack (at the rear)

The earphones with a remote control

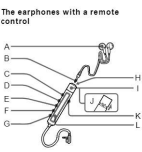

- 1 Headphones / earphones
- 2 Stereo mini-plug
- 3 M (mute) button
- 4 AVLS (Automatic Volume Limiter System) button
- 5 SOUND button
- 6 RPT (Repeat) button
- 7 EXT (Eject) button
- 8 HOLD (Locking the control) switch
- 9 VOL+ (Volume Up) button
- 10 VOL- (Volume Down) button
- 11 DC IN 3V jack (at the rear)
- 12 Display window

* The stop button also operates as the reset button, depending on the function.

The display window of the remote control

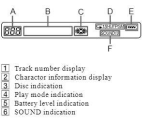

The battery charging stand

